



# 2022/23 CATALOGUE



### LONG NOSE PLIERS

- Chrome-Nickel steel for longer life
- Non-slip bi-material handle



CR-NI



Item No.	Size	EAN	Inner	Outer
200001	160 mm (6 in.)	69426292+ 0369 8	6	36

### WIRE STRIPPER

- Chrome-Vanadium steel
- Non-slip bi-material handle

CR-V



Item No.	Size	EAN	Inner	Outer
200025	160 mm (6 in.)	69426292+ 0381 0	6	36

### INSULATED COMBINATION PLIERS

- VDE/GS certified
- 1000 V insulated
- Chrome-Vanadium steel
- Non-slip bi-material handle

CR-V



Item No.	Size	EAN	Inner	Outer
201011	200 mm (8 in.)	69426292+ 1437 3	6	24

### DIAGONAL PLIERS

- Chrome-Nickel steel for longer life
- Non-slip bi-material handle



CR-NI



Item No.	Size	EAN	Inner	Outer
200005	160 mm (6 in.)	69426292+ 0371 1	6	36

### CURVED JAW LOCKING PLIERS

- Chrome-Vanadium steel
- Double dipped handle

CR-V



Item No.	Size	EAN	Inner	Outer
200555	250 mm (10 in.)	69426292+ 0429 9	6	12

### INSULATED WIRE STRIPPER

- VDE/GS certified
- 1000 V insulated
- Chrome-Vanadium steel
- Non-slip bi-material handle

CR-V



Item No.	Size	EAN	Inner	Outer
201025	160 mm (6 in.)	69426292+ 1438 0	6	24

### LINESMAN PLIERS

- Chrome-Nickel steel for longer life
- Non-slip bi-material handle



CR-NI



Item No.	Size	EAN	Inner	Outer
200011	190 mm (7-1/2 in.) high leverage	69426292+ 0374 2	6	24

### INSULATED LONG NOSE PLIERS

- VDE/GS certified
- 1000 V insulated
- Chrome-Vanadium steel
- Non-slip bi-material handle

CR-V



Item No.	Size	EAN	Inner	Outer
201003	200 mm (8 in.)	69426292+ 1435 9	6	24

### 3 PC INSULATED PLIERS SET

- 160 mm (6 in.) diagonal pliers
- 160 mm (6 in.) long nose pliers
- 200 mm (8 in.) combination pliers
- VDE/GS certified
- 1000 V insulated

CR-V



Item No.	Size	EAN	Inner	Outer
201083	3 pc	69426292+ 8642 4	3	12

### BENT NOSE PLIERS

- Chrome-Vanadium steel
- Non-slip bi-material handle

CR-V



Item No.	Size	EAN	Inner	Outer
200017	160 mm (6 in.)	69426292+ 0377 3	6	36

### INSULATED DIAGONAL PLIERS

- VDE/GS certified
- 1000 V insulated
- Chrome-Vanadium steel
- Non-slip bi-material handle

CR-V



Item No.	Size	EAN	Inner	Outer
201005	160 mm (6 in.)	69426292+ 1436 6	6	24

### CIRCLIP PLIERS STRAIGHT EXTERIOR

- Chrome-Vanadium steel
- Double dipped handle
- 1.8 mm tip diameter

CR-V



Item No.	Size	EAN	Inner	Outer
202011	175 mm (7 in.)	69426292+ 1440 3	6	24

### CIRCLIP PLIERS STRAIGHT INTERIOR

- Chrome-Vanadium steel
- Double dipped handle
- 1.8 mm tip diameter



Item No.	Size	EAN	Inner	Outer
202013	175 mm (7 in.)	69426292+	6	24

### CIRCLIP PLIERS BENT EXTERIOR

- Chrome-Vanadium steel
- Double dipped handle
- 1.8 mm tip diameter



Item No.	Size	EAN	Inner	Outer
202015	175 mm (7 in.)	69426292+	6	24

### CIRCLIP PLIERS BENT INTERIOR

- Chrome-Vanadium steel
- Double dipped handle
- 1.8 mm tip diameter



Item No.	Size	EAN	Inner	Outer
202017	175 mm (7 in.)	69426292+	6	24

### 4 PC CIRCLIP PLIERS SET

- Internal and external use
- 0°, 45°, 90° tips
- 1.4 mm tip diameter



Item No.	Size	EAN	Inner	Outer
202024	150 mm (6 in.)	69426292+	6	24

### SLOTTED INSULATED SCREWDRIVERS

- VDE/GS certified
- 1000 V insulated
- Chrome-Vanadium steel blade
- Non-slip, 3-color, bi-material handle

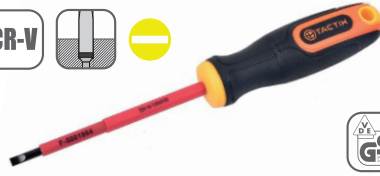
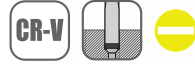

Item No.	Size	EAN	Inner	Outer
205501	3 x 75 mm	69426292+	6	60
205503	4 x 100 mm	1451 9	6	60
205505	5.5 x 125 mm	1452 6	6	60

### PHILLIPS INSULATED SCREWDRIVERS

- VDE/GS certified
- 1000 V insulated
- Chrome-Vanadium steel blade
- Non-slip, 3-color, bi-material handle



Item No.	Size	EAN	Inner	Outer
205511	#0 x 60 mm	1453 3	6	60
205513	#1 x 80 mm	1454 0	6	60
205515	#2 x 100 mm	1455 7	6	60

### 12 PC INSULATED INTERCHANGEABLE SCREWDRIVER SET

- VDE/GS certified
- 1000 V insulated
- Interchangeable shank
- Include 1 pc VDE handle, 10 pc S2 steel interchangeable VDE shank
- 2.0, 2.5, 3.0, 3.5, 4.0, 5.5, 6.5 mm
- #0, #1, #2,
- 1 pc VDE tester 125-250 V
- Nylon pouch included



Item No.	Size	EAN	Inner	Outer
205605VD	12 pc	69426292+	6	24

### 6 PC INSULATED SCREWDRIVER SET

- VDE/GS certified
- 1000 V insulated
- Chrome-Vanadium steel blade
- 3 x 75 mm, 4 x 100 mm & 5.5 x 125 mm
- #0 x 60 mm, #1 x 80 mm & #2 x 100 mm



Item No.	Size	EAN	Inner	Outer
205601	6 pc	69426292+	6	24

### 6 PC CHS SCREWDRIVER SET

- 5 x 100 mm (3/16 x 4 in.), 5 x 150 mm (3/16 x 6 in.), 6 x 100 mm (1/4 x 4 in.), 6 x 150 mm (1/4 x 6 in.)
- #1 x 100 mm (4 in.), #2 x 100 mm (4 in.)



Item No.	Size	EAN	Inner	Outer
205775	6 pc	69426292+	6	24

### 10 PC CHS SCREWDRIVER SET

- 5 x 75 mm (3/16 x 3 in.), 5 x 100 mm (3/16 x 4 in.), 5 x 150 mm (3/16 x 6 in.), 6 x 38 mm (1/4 x 1-1/2 in.), 6 x 100 mm (1/4 x 4 in.), 6 x 150 mm (1/4 x 6 in.)
- #1 x 100 mm (4 in.), #2 x 38 mm (1-1/2 in.), #2 x 100 mm (4 in.), #3 x 150 mm (6 in.)



Item No.	Size	EAN	Inner	Outer
205776	10 pc	69426292+	6	12

## SLOTTED CHS SCREWDRIVERS

- Chrome-Vanadium steel blade
- Magnetic tip



Item No.	Size	EAN 69426292+	Inner	Outer
205613	3.0 x 100 mm (1/8 x 4 in.)	0003 1	12	96
205614	3.0 x 150 mm (1/8 x 6 in.)	0004 8	12	96
205627	6.0 x 100 mm (1/4 x 4 in.)	0014 7	12	96
205628	6.0 x 125 mm (1/4 x 5 in.)	0015 4	12	72
205632	8.0 x 150 mm (5/16 x 6 in.)	0019 2	12	72
205635	10.0 x 200 mm (3/8 x 8 in.)	0020 8	12	72

## PHILLIPS CHS SCREWDRIVERS

- Chrome-Vanadium steel blade
- Magnetic tip



Item No.	Size	EAN 69426292+	Inner	Outer
205646	#1 x 100 mm (4 in.)	0024 6	12	96
205647	#1 x 150 mm (6 in.)	0025 3	12	96
205653	#2 x 125 mm (5 in.)	0028 4	12	72
205655	#2 x 200 mm (8 in.)	0029 1	12	72
205656	#2 x 250 mm (10 in.)	0030 7	12	72
205659	#3 x 150 mm (6 in.)	0031 4	12	72

## 9 PC LONG HEX KEY SET

- Chrome-Vanadium steel
- 2-component clip



Item No.	Size	EAN 69426292+	Inner	Outer
206001	1.5, 2, 2.5, 3, 4, 5, 6, 8 & 10 mm	0460 2	6	36
206003	1/16, 5/64, 3/32, 1/8, 5/32, 3/16, 1/4, 5/16 & 3/8 in.	0461 9	6	36

## 9 PC BALL END LONG HEX KEY SET

- Chrome-Vanadium steel
- 2-component clip



Item No.	Size	EAN 69426292+	Inner	Outer
206005	1.5, 2, 2.5, 3, 4, 5, 6, 8 & 10 mm	0462 6	6	36
206007	1/16, 5/64, 3/32, 1/8, 5/32, 3/16, 1/4, 5/16 & 3/8 in.	0463 3	6	36

## 9 PC LONG TORX® KEY SET

- Chrome-Vanadium steel
- 2-component clip

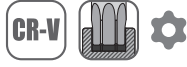

Item No.	Size	EAN 69426292+	Inner	Outer
206009	T-10, 15, 20, 25, 27, 30, 40, 45 & 50	0464 0	6	36

TORX® IS A TRADEMARK OF TRAXON FASTENING SYSTEMS.

## ADJUSTABLE WRENCH

- Laser etched mm/in. scale
- Chrome-Vanadium steel
- Heavy-duty



Item No.	Size	EAN 69426292+	Inner	Outer
210011	150 mm (6 in.)	2952 0	6	36
210013	200 mm (8 in.)	2953 7	6	36
210015	250 mm (10 in.)	2954 4	6	24
210017	300 mm (12 in.)	2955 1	6	12
210019	375 mm (15 in.)	2956 8	6	12

## C-CLAMP

- Heavy-duty cast-iron body
- For industrial and automotive work



Item No.	Size	EAN 69426292+	Inner	Outer
215001	50 mm (2 in.)	0257 8	6	60
215003	75 mm (3 in.)	0258 5	6	24
215005	100 mm (4 in.)	0259 2	6	12
215007	125 mm (5 in.)	0260 8	6	12
215009	150 mm (6 in.)	0261 5	4	8
215011	200 mm (8 in.)	0262 2	4	8

## F-CLAMP

- All steel construction and swivel handle for more clamp force
- Non-slip bi-material handle



Item No.	Size	EAN 69426292+	Inner	Outer
215227	300 x 120 mm	0615 6	4	8
215229	400 x 120 mm	0616 3	4	8
215233	600 x 120 mm	0618 7	2	4

## BENCH VISE WITH SWIVEL BASE

- Replaceable hardened jaw
- Swivel base
- Polished anvil

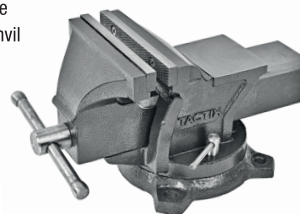

Item No.	Size	EAN 69426292+	Inner	Outer
216004	100 mm (4 in.)	2980 3	0	2
216005	125 mm (5 in.)	2981 0	0	2
216006	150 mm (6 in.)	2982 7	0	1

## RIVET GUN

- Heavy-duty
- 2.4 mm (3/32 in.), 3.2 mm (1/8 in.), 4.0 mm (5/32 in.) & 4.8 mm (3/16 in.)



Item No.	Size	EAN 69426292+	Inner	Outer
217001	250 mm (10 in.)	0853 2	6	12

## HEAVY-DUTY RIVET GUN

- Single pull action for fast, repetitive applications
- 3.2 mm (1/8 in.), 4.0 mm (5/32 in.), 4.8 mm (3/16 in.), 6.0 mm (15/64 in.) & 6.4 mm (1/4 in.)

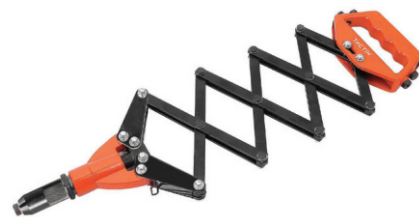

Item No.	Size	EAN 69426292+	Inner	Outer
217025		3356 5	0	6

## LONG-ARM RIVET GUN

- Industrial compound action riveter with high leverage long tubular handle
- 2.4 mm (3/32 in.), 3.2 mm (1/8 in.), 4.0 mm (5/32 in.) & 4.8 mm (3/16 in.)



Item No.	Size	EAN 69426292+	Inner	Outer
217029		3357 2	0	10

### CLAW HAMMER

- Fully polished forged hammer head
- Non-slip bi-material fiberglass handle



Item No.	Size	EAN 69426292+	Inner	Outer
221007	570 g (20 oz.)	0675 0	6	12

### ROOFING HAMMER

- Tubular handle
- Non-slip bi-material soft grip



Item No.	Size	EAN 69426292+	Inner	Outer
224103	600 g	0714 6	6	12

### 3 PC CHISEL SET

- Chrome vanadium steel
- 10, 12, 16 mm (3/8, 1/2, 5/8 in.)



Item No.	Size	EAN 69426292+	Inner	Outer
230103	3 pc	3476 0	10	40

### CLAW HAMMER

- Fully polished forged hammer head
- Tubular handle with non-slip bi-material soft grip



Item No.	Size	EAN 69426292+	Inner	Outer
221073	450 g (16 oz.)	0683 5	6	12
221075	570 g (20 oz.)	0684 2	6	12

### 6 PC PIN PUNCH SET

- Chrome vanadium steel
- 2, 3, 4, 5, 6, 8 mm (3/32, 1/8, 5/32, 3/16, 1/4, 5/16 in.)



Item No.	Size	EAN 69426292+	Inner	Outer
230011	150 mm (6 in.)	1481 6	6	24

### CORNER RULER-ALUMINUM

- High quality aluminum for durability
- Lightweight



Item No.	Size	EAN 69426292+	Inner	Outer
239013	300 x 165 mm	1487 8	6	24

### CLAW HAMMER

- Fully polished forged hammer head
- Wood handle



Item No.	Size	EAN 69426292+	Inner	Outer
221213	450 g (16 oz.)	3847 8	6	12
221215	570 g (20 oz.)	3848 5	6	12

### 3 PC NAIL SET

- Chrome vanadium steel
- 0.8, 1.6, 2.4 mm (1/32, 1/16, 3/32 in.)
- Soft handle



Item No.	Size	EAN 69426292+	Inner	Outer
230033	3 pc	3475 3	10	60

### CARPENTER SQUARE-STEEL

- Hardened steel for durability and long life



Item No.	Size	EAN 69426292+	Inner	Outer
239043	300 x 200 mm (12 x 8 in.)	3378 7	12	60
239055	610 X 406 mm (24 x 16 in.)	3379 4	6	24

### BALL PEIN HAMMER

- Fully polished forged hammer head
- Non-slip bi-material fiberglass handle



Item No.	Size	EAN 69426292+	Inner	Outer
222007	450 g (16 oz.)	0691 0	6	12
222011	910 g (32 oz.)	0693 4	4	8
222013	1200 g (40 oz.)	0694 1	4	8

### CENTER PUNCH

- Chrome vanadium steel



Item No.	Size	EAN 69426292+	Inner	Outer
230085	6 x 100 mm	9031 5	10	60

### COMBINATION RULER

- Stainless steel ruler



Item No.	Size	EAN 69426292+	Inner	Outer
239111	300 mm	1488 5	6	24

### BEVEL

- Stainless steel ruler
- Movable blade helps copy an angle and transfer it onto another surface



Item No.	Size	EAN 69426292+	Inner	Outer
239161	200 mm	1489 2	6	24

### RULER-STAINLESS STEEL

- Stainless steel
- Permanently etched graduation



Item No.	Size	EAN 69426292+	Inner	Outer
239216	600 mm (24 in.)	2883 7	10	60
239220	1000 mm (39 in.)	2884 4	10	60

### LONG TAPE MEASURE-STEEL BLADE

- Impact resistant bi-material non-slip case
- 0.15 mm thick steel blade



Item No.	Size	EAN 69426292+	Inner	Outer
240510	10 m (33 ft.) x 10 mm	0361 2	6	24
240520	20 m (66 ft.) x 10 mm	0362 9	6	24

### LEVEL-I STYLE

- 3 vials-0, 45, 90°
- Aluminum I-beam frame



Item No.	Size	EAN 69426292+	Inner	Outer
250110	300 mm (11-3/4 in.)	3862 1	0	24
250112	450 mm (17-3/4 in.)	3858 4	0	24
250113	600 mm (23-1/2 in.)	3859 1	0	24
250116	900 mm (35-1/2 in.)	3860 7	0	24
250119	1200 mm (47-1/4 in.)	3861 4	0	12

### LEVEL-TORPEDO STYLE

- 3 vials-0, 45, 90°
- With magnetic base
- Accuracy 1.0 mm/m



Item No.	Size	EAN 69426292+	Inner	Outer
253005	225 mm (9 in.)	0307 0	6	36

### SNAP-OFF KNIFE

- Zinc alloy body
- 1 pc SK5 blade included



Item No.	Size	EAN 69426292+	Inner	Outer
260005	9 mm	2320 7	6	36

### SNAP-OFF KNIFE

- 1 pc SK5 blades included



Item No.	Size	EAN 69426292+	Inner	Outer
260036	18 mm	5811 7	6	36

### SNAP-OFF KNIFE

- Non-slip soft grip
- 3 pc SK2 blades included



Item No.	Size	EAN 69426292+	Inner	Outer
260039	18 mm	5964 0	6	36

### HIGH TENSION HACKSAW FRAME

- Durable one-piece body for ultra-high tension
- Adjustable tension mechanism
- Non-slip ergonomic soft handle
- With bi-metal saw blade



Item No.	Size	EAN 69426292+	Inner	Outer
267005	300 mm (12 in.)	7215 1	6	12

### HEAVY-DUTY HACKSAW FRAME

- Heavy-duty construction
- Non-slip soft handle



Item No.	Size	EAN 69426292+	Inner	Outer
267007	300 mm (12 in.)	2648 2	6	12



## INSULATED JUNIOR HACKSAW

- 1000 V insulated



Item No.	Size	EAN	Inner	Outer
267117VD	150 mm (6 in.)	69426292+ 9356 9	6	24

## JUNIOR HACKSAW BLADE

- 150 mm (6 in.)
- SK4



Item No.	Size	EAN	Inner	Outer
267401	2 pc 24 T	69426292+ 1752 7	10	100

## TIN SNIP

- Non-slip double dipped handle



Item No.	Size	EAN	Inner	Outer
273111	200 mm (8 in.)	0473 2	6	36
273113	250 mm (10 in.)	0474 9	6	24
273115	300 mm (12 in.)	0475 6	6	12
273117	350 mm (14 in.)	3383 1	6	12

## CABLE CUTTER

- Non-slip bi-material handle



Item No.	Size	EAN	Inner	Outer
273203	200 mm (8 in.)	69426292+ 7161 1	6	36

## PLUMB BOB

- Removable brass top for easy, centered string installation
- With cotton line



Item No.	Size	EAN	Inner	Outer
283903	200 g (7 oz.)	2761 8	6	24

## BOLT CUTTER

- 65 Mn cutting blade
- Non-slip bi-material handle



Item No.	Size	EAN	Inner	Outer
275111	200 mm (8 in.)	0476 3	6	36

## BOLT CUTTER

- Cr-Mo cutting blade
- Non-slip bi-material handle



Item No.	Size	EAN	Inner	Outer
275113	300 mm (12 in.)	0477 0	6	12
275115	350 mm (14 in.)	0478 7	5	10
275117	450 mm (18 in.)	0479 4	0	6
275119	600 mm (24 in.)	0480 0	0	4
275121	750 mm (30 in.)	0481 7	0	3
275123	900 mm (36 in.)	0482 4	0	2

## GLASS CUTTER

- With 6 tungsten carbide wheels

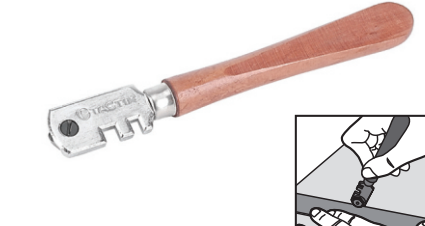

Item No.	Size	EAN	Inner	Outer
284903	135 mm (5-1/2 in.)	2765 6	10	60

## TILE CUTTER

- High-leverage construction makes cutting easier and reduces fatigue
- Tungsten carbide cutting wheel
- Max 10 mm cutting thickness

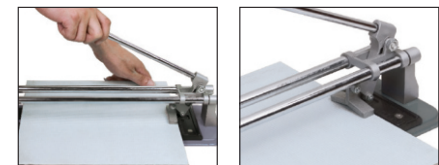

Item No.	Size	EAN	Inner	Outer
284201	400 mm (16 in.)	1773 2	0	10
284202	3 pc spare wheels	5034 0	0	100

## HEAVY-DUTY TILE CUTTER

- Parallel cuts
- Max 12 mm cutting thickness
- Non-slip bi-material grip
- Gauge for straight cutting
- Tungsten carbide cutting wheel

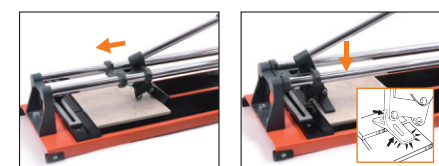
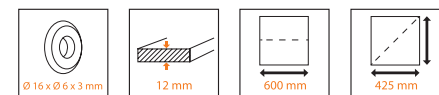

Item No.	Size	EAN	Inner	Outer
284206	600 mm (24 in.)	2319 1	0	2

### PUTTY KNIFE-FLEXIBLE

- Stainless steel blade;
- Non-slip bi-material handle



Item No.	Size	EAN 69426292+	Inner	Outer
305001	38 mm (1-1/2 in.)	4518 6	10	60
305002	50 mm (2 in.)	4519 3	10	60

### JOINT KNIFE-FLEXIBLE

- Stainless steel blade
- Non-slip bi-material handle



Item No.	Size	EAN 69426292+	Inner	Outer
305003	75 mm (3 in.)	4520 9	10	60
305004	100 mm (4 in.)	4521 6	10	60
305006	150 mm (6 in.)	4522 3	10	60

### SHARPENING STONE

- Silicon carbide
- 120# and 240#

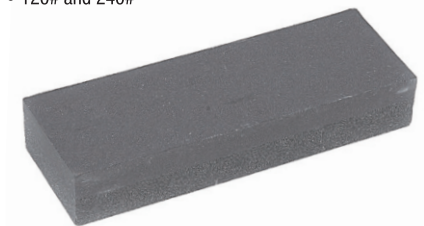

Item No.	Size	EAN 69426292+	Inner	Outer
310213	150 mm (6 in.)	2785 4	6	24

### TUBE CUTTER

- Alloy steel blade
- Zinc alloy body

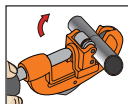

Item No.	Size	EAN 69426292+	Inner	Outer
340030	3-30 mm (1/8 in.-1-1/8 in.)	2759 5	6	36
340041	2 pc replace blade	5250 4	10	60

### 1/2 in. DR. SOCKET 6PT

- Chrome-Vanadium steel with satin finish



Item No.	Size	EAN 69426292+	Inner	Outer
361002	5/16 in.	1118 1	6	96
361003	3/8 in.	1119 8	6	96
361005	1/2 in.	1121 1	6	96
361008	5/8 in.	1124 2	6	96
361010	3/4 in.	1126 6	4	72
361013	7/8 in.	1129 7	4	72
361016	1 in.	1132 7	4	72
361018	1-1/8 in.	1134 1	4	72
361020	1-1/4 in.	1136 5	4	48
361031	8 mm	1137 2	6	96
361033	10 mm	1139 6	6	96
361035	12 mm	1141 9	6	96
361036	13 mm	1142 6	6	96
361037	14 mm	1143 3	6	96
361038	15 mm	1144 0	6	96
361039	16 mm	1145 7	6	96
361042	19 mm	1148 8	6	96
361043	20 mm	1149 5	4	72
361045	22 mm	1151 8	4	72
361047	24 mm	1153 2	4	72
361051	28 mm	1157 0	4	72
361052	29 mm	1158 7	4	48
361053	30 mm	1159 4	4	48
361054	32 mm	1160 0	4	48

### 1/2 in. DR. RATCHET HANDLE

- 45 tooth



Item No.	Size	EAN 69426292+	Inner	Outer
362332	240 mm (9-1/2 in.)	1392 5	6	24

### 3/4 in. DR. RATCHET HANDLE

- Chrome-Vanadium steel
- 43 tooth



Item No.	Size	EAN 69426292+	Inner	Outer
362401	500 mm (19-3/4 in.)	3457 9	2	8

### 3/4 in. DR. IMPACT SOCKET 6PT

- Chrome-Vanadium steel with black phosphate finish



Item No.	Size	EAN 69426292+	Inner	Outer
363001	17 mm	6849 9	8	48
363003	19 mm	6850 5	8	48
363006	22 mm	6852 9	8	48
363008	24 mm	6854 3	8	48
363012	28 mm	6858 1	4	32
363014	30 mm	6860 4	4	32
363016	32 mm	6862 8	4	32
363019	35 mm	6865 9	4	32
363022	38 mm	6867 3	4	32
363024	40 mm	6868 0	2	16
363034	50 mm	6875 8	2	16

### 3/4 in. DR. IMPACT SOCKET 12PT

- Chrome-Vanadium steel with black phosphate finish



Item No.	Size	EAN 69426292+	Inner	Outer
363051	3/4 in.	6876 5	8	48
363053	7/8 in.	6878 9	8	48
363054	15/16 in.	6879 6	8	48
363055	1 in.	6880 2	8	48
363059	1-1/4 in.	6884 0	4	32
363061	1-3/8 in.	6886 4	4	32
363063	1-1/2 in.	6888 8	4	32
363067	1-3/4 in.	6891 8	2	16

### 1/2 in. DR. IMPACT EXTENSION BAR

- Chrome-Vanadium steel with black phosphate finish



Item No.	Size	EAN 69426292+	Inner	Outer
363703	75 mm (3 in.)	4343 4	12	36
363705	125 mm (5 in.)	4344 1	12	36

### 1/2 in. DR. IMPACT UNIVERSAL JOINT

- Chrome-Vanadium steel with black phosphate finish



Item No.	Size	EAN 69426292+	Inner	Outer
363709	1/2 in. Dr.	4346 5	12	48

### 1/2 in. DR. IMPACT ADAPTOR

- Chrome-Vanadium steel with black phosphate finish

1/2 in. (F) → 3/8 in. (M)



CR-V

Item No.	Size	EAN	Inner	Outer
363711	1/2 in. Dr.	69426292+	12	72

### 7 PC 3/8 in. DR. DEEP IMPACT SOCKET SET

- Chrome-Vanadium steel with black phosphate finish
- 3/8, 7/16, 1/2, 9/16, 5/8, 11/16, 3/4 in.



CR-V

Item No.	Size	EAN	Inner	Outer
363787	7 pc	69426292+	6	12

### 7 PC 1/2 in. DR. DEEP IMPACT SOCKET SET

- Chrome-Vanadium steel with black phosphate finish
- 1/2, 9/16, 5/8, 11/16, 3/4, 13/16, 7/8 in.



CR-V

Item No.	Size	EAN	Inner	Outer
363807	1/2 in. Dr.	69426292+	6	12

### 10 PC 1/2 in. DR. IMPACT SOCKET SET

- Chrome-Vanadium steel with black phosphate finish
- 10, 12, 13, 14, 15, 16, 17, 18, 19, 22 mm



CR-V

Item No.	Size	EAN	Inner	Outer
363820	10 pc	69426292+	0	6

### 3 PC 1/2 in. DR. IMPACT WHEEL NUT SOCKET

- Inner/outer nylon sleeve to prevent damage to shells and nuts
- Chrome-Molybdenum steel
- 17, 19, 21 mm



CR-MO

Item No.	Size	EAN	Inner	Outer
363803	3 pc	69426292+	0	12

### 113 PC 1/4 in. & 1/2 in. DR. SOCKET SET

- 18 pc 1/2 in. Dr. socket: 10, 11, 12, 13, 14, 15, 16, 17, 18, 19, 20, 21, 22, 23, 24, 27, 30 & 32mm
- 12 pc 1/4 in. Dr. socket: 4, 4.5, 5, 5.5, 6, 7, 8, 9, 10, 11, 12 & 13mm
- 10 pc 1/4 in. Dr. deep well socket: 4, 5, 6, 7, 8, 9, 10, 11, 12 & 13mm
- 4 pc double flexible socket wrench: 8 x 9, 10 x 11, 12 x 13 & 14 x 15mm
- 14 pc combination wrench: 7, 8, 9, 10, 11, 12, 13, 14, 15, 16, 17, 18, 19 & 22mm
- 31 pc 1 in. Cr-v bit:
  - ⊕ #1, #2 & #3;
  - ⊖ 4, 5.5 & 6.5mm;
  - ⊗ 3, 4, 5 & 6mm;
  - ⊙ #0, #1, #2(2) & #3;
  - ⊕ T-10(2), T-15(3), T-20(2), T-25(3), T-30(3) & T-40(2)
- 6 pc 5/16 in. S2 bit:
  - ⊙ 10, 12 & 14;
  - ⊗ 45, 50 & 55
- 4 pc hex key: 1.3, 1.5, 2 & 2.5mm
- 2 pc 1/4 in. Dr. extension bar 50 & 100mm
- 1 pc 1/4 in. Dr. universal joint
- 1 pc 1/4 in. Dr. spinner handle
- 1 pc 1/4 in. Dr. socket bit holder
- 1 pc 1/4 in. Dr. slide T-bar
- 2 pc 1/4 in. & 1/2 in. Dr. ratchet handle
- 2 pc 1/2 in. Dr. extension bar 125 & 250mm
- 2 pc 1/2 in. Dr. spark plug socket 16mm & 21mm
- 1 pc 1/2 in. Dr. universal joint
- 1 pc 1/2 in. x 5/16 in. adapter
- 1 pc quick change chuck



CR-V

Item No.	Size	EAN	Inner	Outer
365031	Metric	69426292+	0	2

TORX® IS A TRADEMARK OF TEXTRON FASTENING SYSTEMS.

### 18 PC 1/2 in. DR. SOCKET SET

- 14 pc 1/2 in. Dr. sockets: 10, 11, 12, 13, 14, 15, 16, 17, 19, 22, 24, 27, 30 & 32 mm
- 1 pc 1/2 in. Dr. x 125 mm extension bar
- 1 pc 1/2 in. Dr. flexible handle
- 1 pc 1/2 in. Dr. universal joint
- 1 pc 1/2 in. Dr. ratchet handle



CR-V

Item No.	Size	EAN	Inner	Outer
365015	Metric	69426292+	0	4

### 16 PC 1/2 in. DR. SOCKET SET

- 13 pc 1/2 in. Dr. sockets: 7/16, 1/2, 9/16, 5/8, 11/16, 3/4, 13/16, 7/8, 15/16, 1, 1-1/16, 1-1/8 & 1-1/4 in.
- 1pc 1/2 in. Dr. flexible handle
- 1pc 1/2 in. Dr. x 125 mm (5 in.) extension bar
- 1pc 1/2 in. Dr. ratchet handle



CR-V

Item No.	Size	EAN	Inner	Outer
365016	SAE	69426292+	0	4

### 23 PC 1/2 in. DR. SOCKET SET

- 19 pc 1/2 in. Dr. socket set: 8, 9, 10, 11, 12, 13, 14, 15, 16, 17, 18, 19, 21, 22, 23, 24, 27, 30 & 32 mm
- 1 pc 1/2 in. Dr. universal joint
- 1 pc 1/2 in. Dr. 125 mm extension
- 1 pc 1/2 in. Dr. 250 mm extension
- 1 pc 1/2 in. Dr. ratchet handle



CR-V

Item No.	Size	EAN	Inner	Outer
365042	Metric	69426292+	0	5

## COMBINATION WRENCH SAE & METRIC

- Chrome-Vanadium steel with satin finish



.S.I.

Item No.	Size	EAN 69426292+	Inner	Outer
370003	6 mm	0540 1	6	72
370005	7 mm	0541 8	6	72
370007	8 mm	0542 5	6	72
370009	9 mm	0543 2	6	72
370011	10 mm	0544 9	6	72
370013	11 mm	0545 6	6	72
370015	12 mm	0546 3	6	72
370017	13 mm	0547 0	6	72
370019	14 mm	0548 7	6	72
370021	15 mm	0549 4	6	72
370023	16 mm	0550 0	6	72
370025	17 mm	0551 7	6	72
370027	18 mm	0552 4	6	72
370029	19 mm	0553 1	6	48
370031	20 mm	0554 8	6	48
370033	21 mm	0555 5	6	48
370035	22 mm	0556 2	6	48
370037	23 mm	0557 9	6	48
370039	24 mm	0558 6	6	36
370041	25 mm	0559 3	6	36
370043	26 mm	0560 0	6	36
370045	27 mm	0561 6	6	24
370047	28 mm	0562 3	6	24
370049	29 mm	0563 0	6	12
370051	30 mm	0564 7	6	12
370053	32 mm	0565 4	6	12
370103	1/4 in.	0566 1	6	72
370105	5/16 in.	0567 8	6	72
370107	3/8 in.	0568 5	6	72
370109	7/16 in.	0569 2	6	72
370111	1/2 in.	0570 0	6	72
370113	9/16 in.	0571 5	6	72
370115	5/8 in.	0572 2	6	72
370117	11/16 in.	0573 9	6	48
370119	3/4 in.	0574 6	6	48
370121	13/16 in.	0575 3	6	48
370123	7/8 in.	0576 0	6	48
370125	15/16 in.	0577 7	6	36
370127	1 in.	0578 4	6	36
370129	1-1/16 in.	0579 1	6	24
370131	1-1/8 in.	0580 7	6	24
370133	1-1/4 in.	0581 4	6	12

## JUMBO COMBINATION WRENCH SAE & METRIC

- Carbon steel



Item No.	Size	EAN 69426292+	Inner	Outer
370054	33 mm	5391 4	6	12
370055	34 mm	5392 1	6	12
370056	35 mm	5393 8	6	12
370057	36 mm	5394 5	6	12
370058	37 mm	5395 2	6	12
370059	38 mm	5396 9	6	12
370062	41 mm	5397 6	3	6
370063	42 mm	5398 3	3	6
370064	43 mm	5399 0	3	6
370065	44 mm	5400 3	3	6
370066	45 mm	5401 0	3	6
370067	46 mm	5402 7	3	6
370068	48 mm	5403 4	3	6
370070	50 mm	5404 1	3	6
370075	55 mm	5405 8	2	4
370080	60 mm	5406 5	2	4
370085	65 mm	5407 2	2	4
370134	1-5/16 in.	5174 3	6	12
370135	1-3/8 in.	5175 0	6	12
370136	1-7/16 in.	5176 7	6	12
370137	1-1/2 in.	4357 1	6	12
370139	1-5/8 in.	5177 4	3	6
370143	1-3/4 in.	5178 1	3	6
370145	1-7/8 in.	5179 8	3	6
370147	2 in.	5180 4	3	6
370151	2-1/8 in.	5181 1	2	4
370155	2-1/4 in.	5182 8	2	4
370159	2-3/8 in.	5183 5	2	4
370163	2-1/2 in.	5184 2	2	4



## 9 PC COMBINATION WRENCH SET-METRIC

- Chrome-Vanadium steel with satin finish
- 6, 8, 9, 10, 12, 13, 14, 17 & 19 mm



CR-V A.N.S.I.

Item No.	Size	EAN 69426292+	Inner	Outer
370501	9 pc	1279 9	6	18

## 9 PC COMBINATION WRENCH SET-SAE

- Chrome-Vanadium steel with satin finish
- 1/4, 5/16, 3/8, 7/16, 1/2, 9/16, 5/8, 11/16 & 3/4 in.



CR-V A.N.S.I.

Item No.	Size	EAN 69426292+	Inner	Outer
370503	9 pc	1280 5	6	18

## 5 PC COMBINATION WRENCH SET-METRIC

- Chrome-Vanadium steel with satin finish
- 8, 10, 12, 14 & 17 mm



CR-V A.N.S.I.

Item No.	Size	EAN 69426292+	Inner	Outer
370511	5 pc	1502 8	6	24

## 5 PC COMBINATION WRENCH SET-SAE

- Chrome-Vanadium steel with satin finish
- 3/8, 7/16, 1/2, 9/16 & 5/8 in.



CR-V A.N.S.I.

Item No.	Size	EAN 69426292+	Inner	Outer
370513	5 pc	1503 5	6	24

## 14 PC COMBINATION WRENCH SET

- Chrome-Vanadium steel with satin finish
- 8, 9, 10, 11, 12, 13, 14, 15, 16, 17, 18, 19, 22, 24 mm
- Nylon tool roll included



CR-V A.N.S.I.

Item No.	Size	EAN 69426292+	Inner	Outer
370534	14 pc	4351 9	0	6

## 14 PC COMBINATION WRENCH SET

- Chrome-Vanadium steel with satin finish
- 3/8, 7/16, 1/2, 9/16, 5/8, 11/16, 3/4, 13/16, 7/8, 15/16, 1, 1-1/16, 1-1/8, 1-1/4 in.
- Nylon tool roll included



CR-V A.N.S.I.

Item No.	Size	EAN 69426292+	Inner	Outer
370535	14 pc	5063 0	0	6

### 23 PC COMBINATION WRENCH SET

- Chrome-Vanadium steel with satin finish
- 6, 7, 8, 9, 10, 11, 12, 13, 14, 15, 16, 17, 18, 19, 20, 21, 22, 23, 24, 25, 27, 30, 32 mm
- Nylon tool roll included



**CR-V** **A.N.S.I.**

Item No.	Size	EAN 69426292+	Inner	Outer
370536	23 pc	4352 6	0	4

### HIGH PRESSURE TIRE GAUGE

- Angled chuck for easy use
- With pocket clip



Item No.	Size	EAN 69426292+	Inner	Outer
386135	10-120 PSI (1.0-8.0 kg/cm <sup>2</sup> )	3430 2	12	120

### CRIMPING PLIER

- Crimping insulated terminals 26-14, 12-10, 22-10
- Cut bolts size: 6-32, 8-32, 10-32, 10-24, 4-40
- Wire stripping AWG #8-#26
- Wire cutting function



Item No.	Size	EAN 69426292+	Inner	Outer
401009	215 mm (8-1/2 in.)	1530 1	6	24

### OIL CAN RIGID HOSE



Item No.	Size	EAN 69426292+	Inner	Outer
382503	250 ml	2791 5	10	60
382505	400 ml	2796 0	10	60

### 5 PC SCREW EXTRACTOR

- #1 (3.1-6.3 mm),
- #2 (6.3-7.9 mm),
- #3 (7.9-)
- #4 (11.1-
- #5 (14.2-



Item No.	Size	EAN 69426292+	Inner	Outer
386405	5 pc	7145 1	10	60

### 3-IN-1 CRIMPING TOOL

- Ratchet function
- Crimps modular connectors in 8P-RJ45 and 6P-RJ11/12 formats
- Cuts and strips formal network and telephone cable.

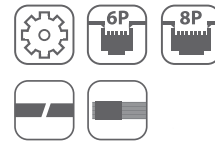

Item No.	Size	EAN 69426292+	Inner	Outer
401013	3-in-1	9353 8	6	24

### PULLER 3-ARM

- Chrome-Vanadium steel
- For external and internal pulling

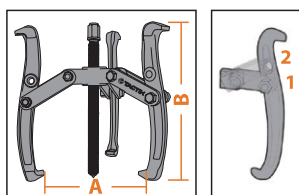

**CR-V**

Item No.	A	B	EAN 69426292+	Outer
383011	75 mm (3 in.)	100 mm (4 in.)	7015 7	10
383013	150 mm (6 in.)	217 mm (8-11/16 in.)	7017 1	6
383014	200 mm (8 in.)	300 mm (12 in.)	7018 8	3

### WIRE STRIPPER

- Stripping cable range: 0.8-2.6 mm (#10-#20 AWG)
- Non-slip bi-material handle



Item No.	Size	EAN 69426292+	Inner	Outer
401001	165 mm (6-1/2 in.)	1527 1	6	24

### TERMINAL CRIMPING TOOL

- Ratchet function
- Crimping insulated terminals: red 0.5-1 mm<sup>2</sup> (#18-#20 AWG), blue 1.5-2.5 mm<sup>2</sup> (#14-#16 AWG), yellow 4-6 mm<sup>2</sup> (#10-#12 AWG).



Item No.	Size	EAN 69426292+	Inner	Outer
401035		9354 5	6	24

### DIGITAL MULTIMETER

- AC Voltage: 200 V/600 V ± (1.2% + 10)
- DC Voltage: 200 mV/2 V/20 V/200 V ± (0.5% + 2), 600 V ± (0.8% + 2)
- DC Current: 20 uA/200 uA/2 mA/20 mA ± (1.0% + 2), 200 mA ± (1.5% + 2), 10 A ± (3% + 2)
- Resistance: 200 Ω ± (0.8% + 3), 2 kΩ/20 kΩ/200 kΩ ± (0.8% + 2), 2 MΩ ± (1.0% + 2)
- Diode test • Data hold

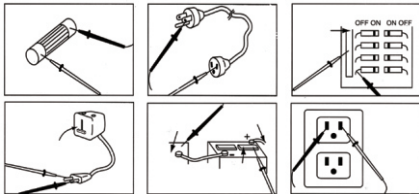

Item No.	Size	EAN	Inner	Outer
403001		69426292+ 2857 8	6	24

### AC CLAMP METER

- AC Voltage: 1000 V ± (1.2% + 5)
- AC Current: 20 A/200 A ± (2.0% + 5), 1000 A ± (2.5% + 7)
- DC Voltage: 1000 V ± (1.0% + 2)
- Resistance :200 Ω/2 KΩ ± (1.0% + 3)
- Continuity test with buzzer
- Diode test
- Date hold
- f



Item No.	Size	EAN	Inner	Outer
403057		69426292+ 2862 2	6	24

### GLUE GUN 10 W EU PLUG

- 230 V EU plug
- 2 pc 7.2 x 100 mm glue included



Item No.	Size	EAN	Inner	Outer
406001EU	10 W EU PLUG	69426292+ 7080 5	12	48

### HEAT GUN 2000 W EU PLUG

- EU plug, 220-240 V, 50 Hz
- Power 2000 W
- 2 temperature set: 440 & 600 °C
- 2 air flow ranges: 250 & 550 l/min.

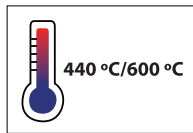

Item No.	Size	EAN	Inner	Outer
406301EU	2000 W EU plug	69426292+ 8073 6	0	10

### INSULATED CABLE KNIFE

- VDE/GS certified
- 1000 V insulated



Item No.	Size	EAN	Inner	Outer
401802	180 mm (7 in.)	69426292+ 5381 5	6	48

### INSULATED DISMANTLING KNIFE

- VDE/GS certified
- 1000 V insulated



Item No.	Size	EAN	Inner	Outer
401803VD	180 mm (7 in.)	69426292+ 9346 0	6	48

### PTFE TAPE

- Provides a strong tight seal for threaded joints
- Easy disassembly



Item No.	Size	EAN	Inner	Outer
530422	12 mm x 10 m (1/2 in. x 33 ft.)	69426292+ 2739 7	48	144
530424	19 mm x 10 m (3/4 in. x 33 ft.)	69426292+ 5558 1	48	144

### GAS PTFE TAPE

- Provides a strong tight seal for threaded joints
- Easy disassembly



Item No.	Size	EAN	Inner	Outer
530430	12 mm x 12 m x 0.1 mm	69426292+ 5908 4	48	144
530431	19 mm x 12 m x 0.15 mm	69426292+ 5909 1	48	144
530432	25 mm x 10 m x 0.15 mm	69426292+ 6239 8	48	144

### 10 PC RIFFLER FILE SET

- Medium grade flat, round and triangular profiles.
- Double ended for twice the life.
- For detail work in wood, plaster, plastic and metal.
- Plastic pouch included.



Item No.	Size	EAN	Inner	Outer
545075	10 pc	69426292+	12	48

### 10 PC NEEDLE FILE SET

- Medium grade flat, round and triangular profiles.
- Double ended for twice the life.
- Plastic pouch included.

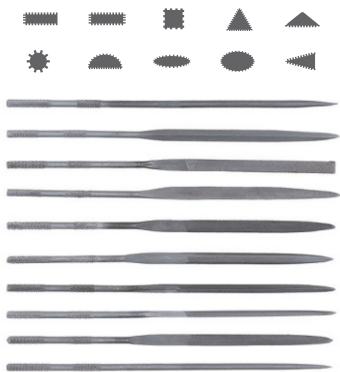

Item No.	Size	EAN	Inner	Outer
545076	10 pc	69426292+	12	48

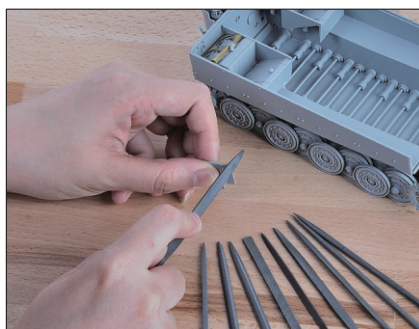

### 7 PC FILE BOX SET

- 6 pc files: Flat, square, round, half-round, triangular & mill
- 1 pc precision file handle
- plastic storage box included.



Item No.	Size	EAN	Inner	Outer
545311	7 pc	69426292+	6	36

### TORPEDO LEVEL

- For leveling machines, audio and video equipment, pool and game tables, electric appliances, and many other items.



Item No.	Size	EAN	Inner	Outer
545317	150 mm (6 in.)	69426292+	12	48

### BULL'S EYE LEVEL

- Made of unbreakable acrylic plastic.
- For leveling machines, audio and video equipment, pool and game tables, electric appliances, and many other items.

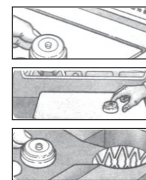

Item No.	Size	EAN	Inner	Outer
545319		69426292+	12	144

### RECTANGULAR TELESCOPING MIRROR

- Telescopic from 11 to 29-1/2 in. (280 to 750 mm)
- Inspection mirror 2 x 3-1/2 in. (50 x 89 mm)



Item No.	Size	EAN	Inner	Outer
545323		69426292+	12	72

### ROUND INSPECTION MIRROR

- Telescopic from 9-1/2 to 27-1/2 in. (241 to 698.5 mm)
- Inspection mirror 2 in. (50 mm)



Item No.	Size	EAN	Inner	Outer
545325		69426292+	12	72

### WEATHER-PROOF PLASTIC TOOL BOX

50 W x 26.3 D x 24 H cm (19-1/2 x 10-3/8 x 9-1/2 in.)

- Built-in organization compartments
- Cam-action ABS latches



WEATHER-PROOF

Item No.	Size	EAN	20' FCL	40' FCL	40' HQ
320100A	50 cm (19-1/2 in.)	694262921756 5	1,584	3,312	4,416

### PLASTIC TOOL BOX

50.8 W x 26 D x 23.2 H cm (20 x 10-1/4 x 9 in.)

- Heavy duty steel latches
- Lift-out carry tray



Item No.	Size	EAN	20' FCL	40' FCL	40' HQ
320342	50.8 cm (20 in.)	694262926017 2	1,440	3,168	3,168

### 61 cm (24 in.) PLASTIC TOOL BOX

- 61 W x 27.7 D x 26.2 H cm  
(24 x 11 x 10-1/4 in.)
- Aluminum comfort-grip top handle
  - 1 x Black PP tray inside
  - 2 x Heavy-duty steel latches



Item No.	Size	EAN	20' FCL	40' FCL	40' HQ
320344	61 cm (24 in.)	694262926187 2	864	1,824	2,432

### 7-DRAWER WIDE ROLL AWAY CABINET

- 68 W x 46 D x 85 H cm (26-1/2 x 18 x 32-1/2 in.) with castors
- 7 Drawers
  - 4pc - 60 W x 40.5 D x 5 H cm (23-5/8 x 16 x 2 in.)
  - 2pc - 60 W x 40.5 D x 10 H cm (23-5/8 x 16 x 4 in.)
  - 1pc - 60 W x 40.5 D x 20 H cm (23-5/8 x 16 x 8 in.)



Removable hardware tray



Item No.	Size	EAN	20' FCL	40' FCL	40' HQ
326027	68 cm (26-1/2 in.)	694262924135 5	56	120	120

### 18-DRAWER CABINET

38.5 W x 16.2 D x 47.5 H cm (15-1/8 x 6-3/8 x 18-5/8 in.)



(Contents not included)

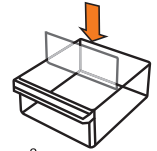

8 x

Item No.	Size	EAN	20' FCL	40' FCL	40' HQ
320634	18-drawer	694262925012 8	768	1,600	2,000

### 39-DRAWER CABINET

38.5 W x 16.2 D x 47.5 H cm (15-1/8 x 6-3/8 x 18-5/8 in.)

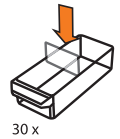

30 x

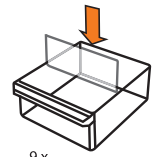

9 x

Item No.	Size	EAN	20' FCL	40' FCL	40' HQ
320636	39-drawer	694262925013 5	768	1,600	2,000

### 60-DRAWER CABINET

38.5 W x 16.2 D x 47.5 H cm (15-1/8 x 6-3/8 x 18-5/8 in.)



(Contents not included)

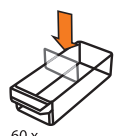

60 x

Item No.	Size	EAN	20' FCL	40' FCL	40' HQ
320638	60-drawer	694262925014 2	768	1,600	2,000